

Douglas DC-1, DC-2, DST (DC-3)

Douglas DC-1

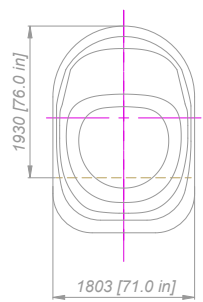

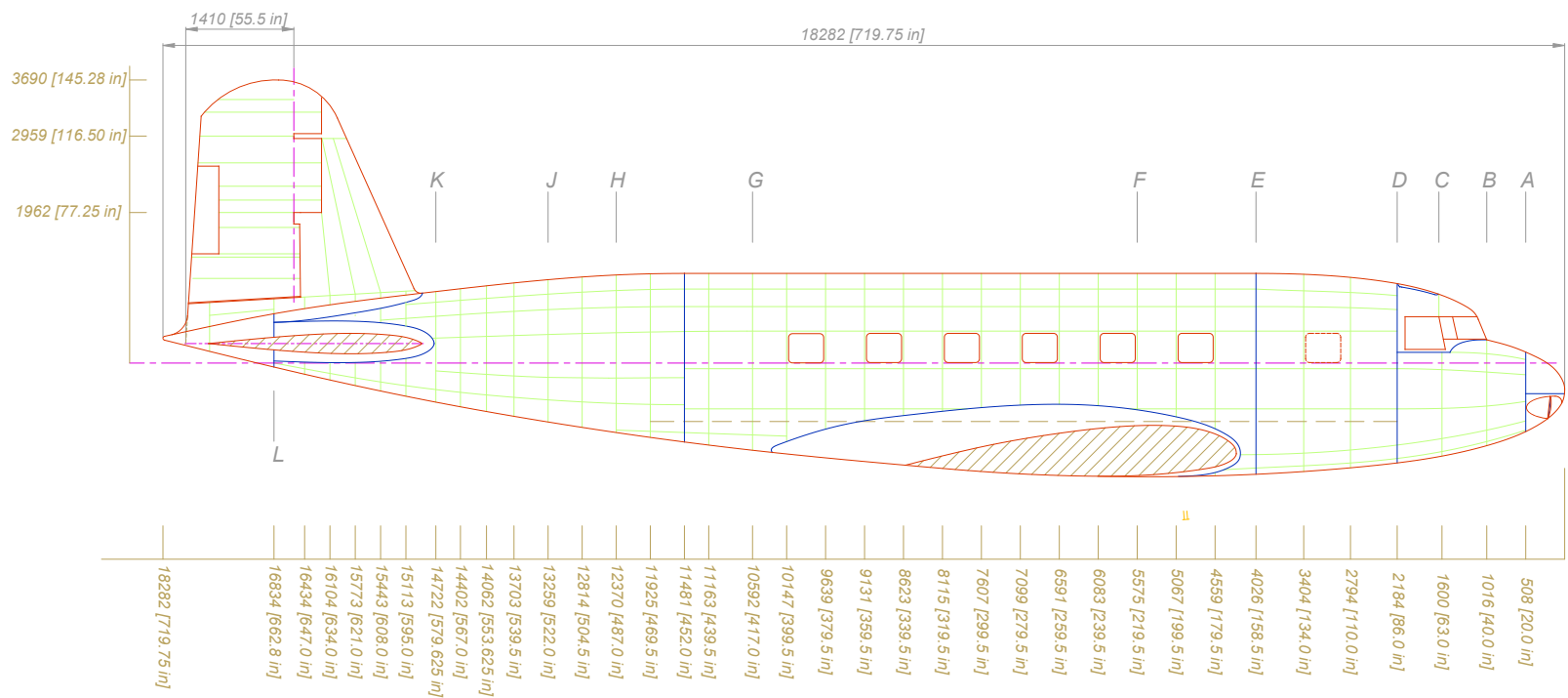
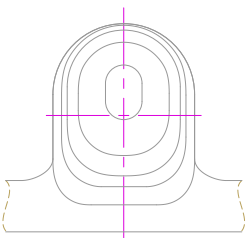
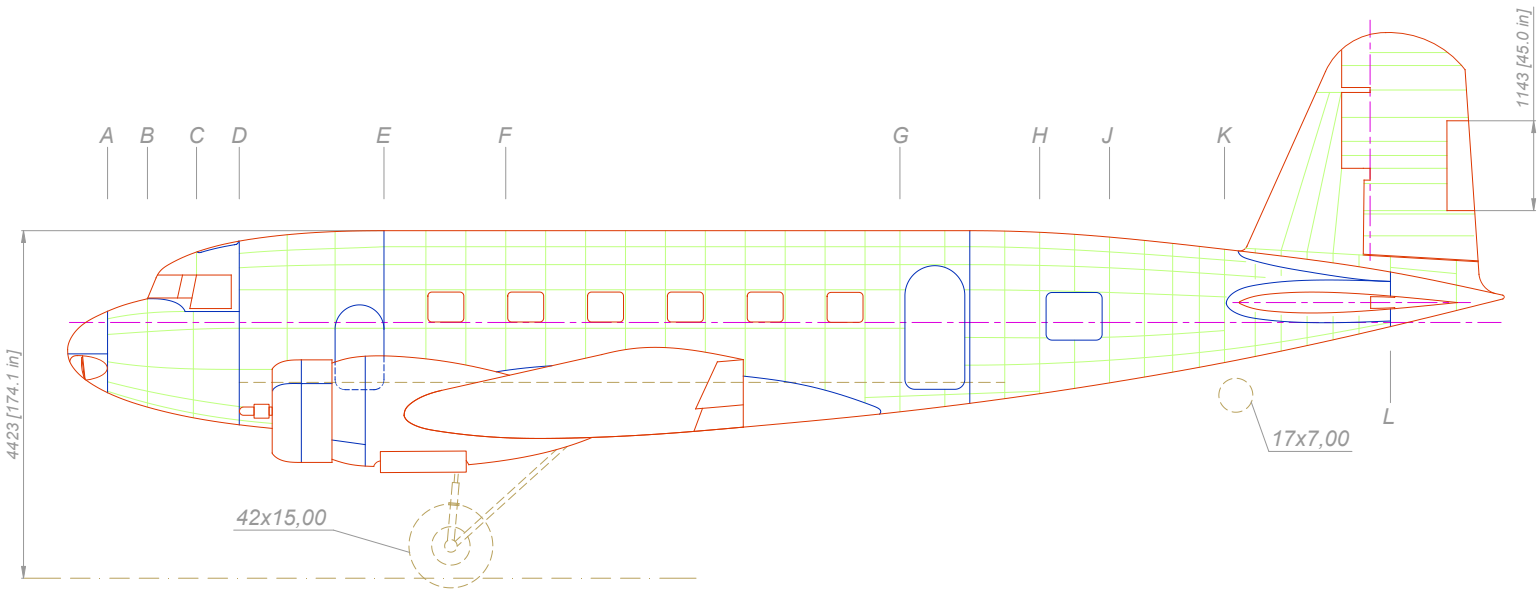
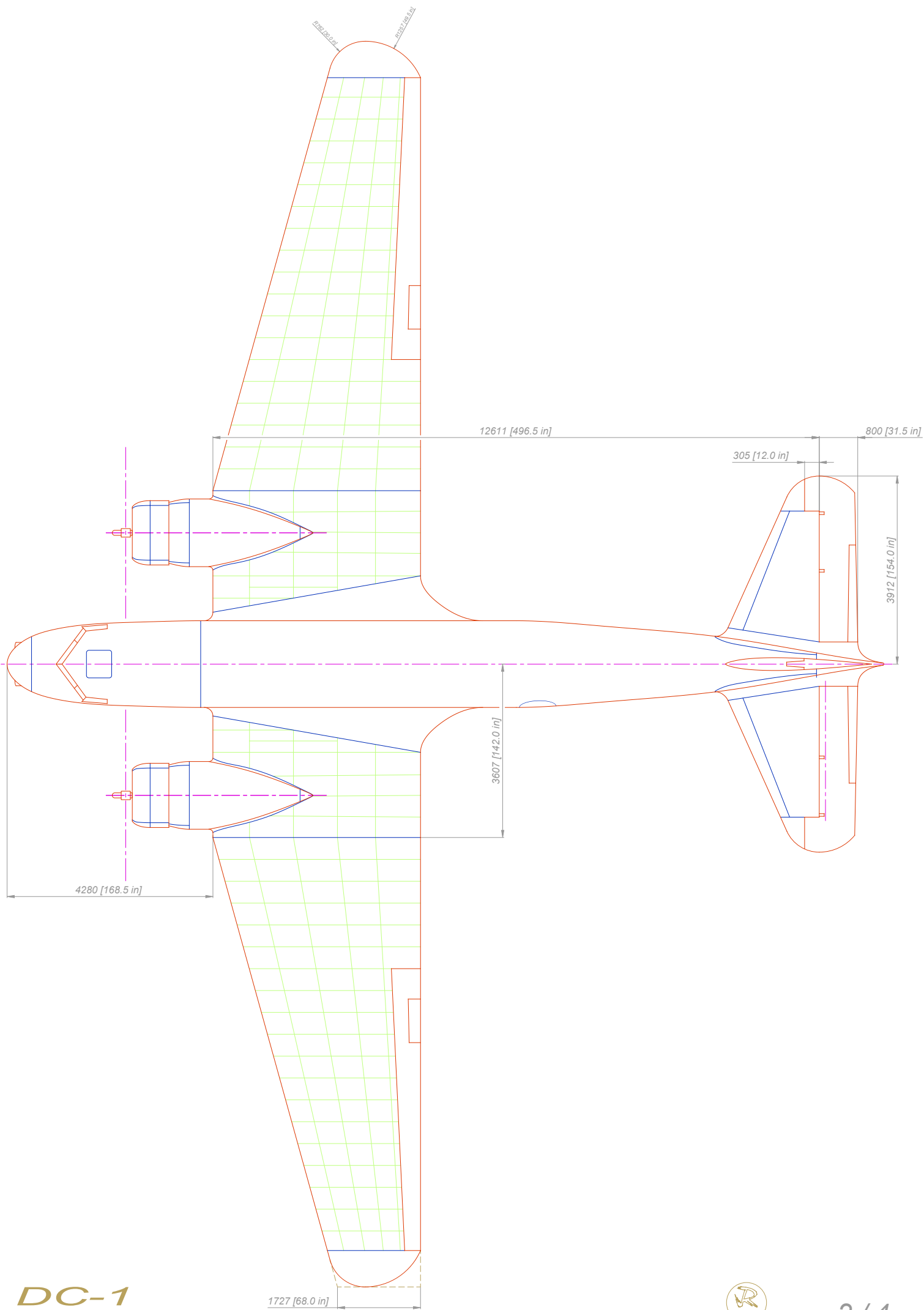

NACA 2209 (+2°)

SGR-1820-F3
710 hp

NACA 2215 (+2°)

152 [6.0 in]

508 [20.0 in]

673 [26.5 in]

857 [33.75 in]

1153 [45.375 in]

1372 [54.0 in]

1599 [62.938 in]

1835 [72.25 in]

2302 [90.625 in]

2731 [107.5 in]

3181 [125.25 in]

3607 [142.0 in]

455 [17.9 in]

909 [35.8 in]

1364 [53.7 in]

1819 [71.6 in]

2273 [89.5 in]

2728 [107.4 in]

3183 [125.3 in]

3637 [143.2 in]

4092 [161.1 in]

4547 [179.0 in]

5001 [196.9 in]

5456 [214.8 in]

5911 [232.7 in]

6365 [250.6 in]

6820 [268.5 in]

7275 [286.4 in]

7729 [304.3 in]

8184 [322.2 in]

8590 [338.188 in]

9347 [368.0 in]

